



7 Feversham Road  
£850 PCM





## Top Flat, 7 Feversham Road, Salisbury, Wiltshire, SP1 3PP

\*\*\* VIEWINGS ON HOLD DUE TO HIGH DEMAND\*\*\*

A modern one bedroom first floor apartment conveniently situated in Salisbury.

A well presented first floor apartment conveniently situated within a short walk of Salisbury town centre, gas central heating.

Located within short walk of the town centre . A modern well presented first floor one bedroom apartment. The accommodation comprises front door with stairs to landing ,leading to fitted kitchen, with integral fridge with freezer box, washing machine, electric hob and oven with extractor over, base units and work surfaces. Light and bright lounge, good sized double bedroom, modern bathroom with shower over the bath, WC and basin. The flat benefits from gas central heating and has carpets and curtains. Parking on road.





## Ground Floor

Approx. 38.1 sq. metres (410.5 sq. feet)

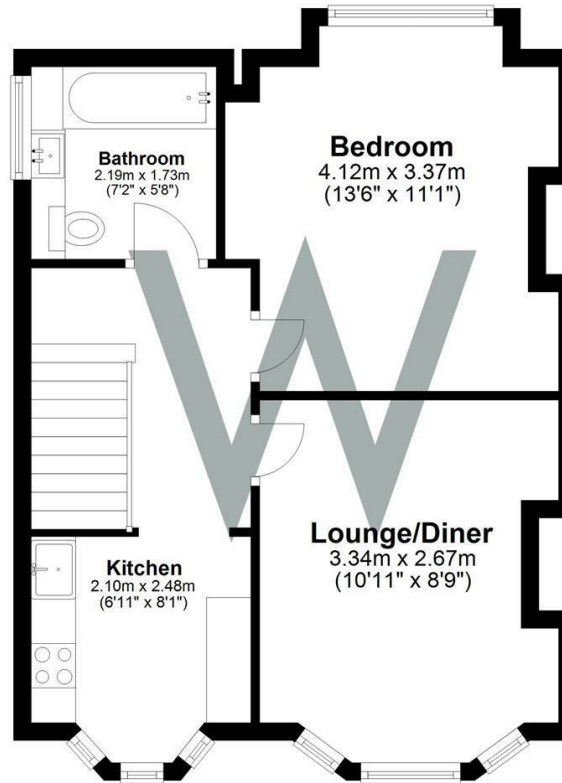

Energy Efficiency Rating		
	Current	Potential
Very energy efficient - lower running costs		
(92 plus) <b>A</b>		
(81-91) <b>B</b>		
(69-80) <b>C</b>	74	74
(55-68) <b>D</b>		
(39-54) <b>E</b>		
(21-38) <b>F</b>		
(1-20) <b>G</b>		
Not energy efficient - higher running costs		
England & Wales EU Directive 2002/91/EC		
Environmental Impact (CO <sub>2</sub> ) Rating		
	Current	Potential
Very environmentally friendly - lower CO <sub>2</sub> emissions		
(92 plus) <b>A</b>		
(81-91) <b>B</b>		
(69-80) <b>C</b>		
(55-68) <b>D</b>		
(39-54) <b>E</b>		
(21-38) <b>F</b>		
(1-20) <b>G</b>		
Not environmentally friendly - higher CO <sub>2</sub> emissions		
England & Wales EU Directive 2002/91/EC		

### Viewing

By confirmed appointment only with the vendor's agent. Telephone 01722 336422.

### Agent's note

Every effort has been made to prepare these particulars as carefully as possible. However, intending purchasers should be aware that their accuracy is not guaranteed, nor do they form part of any contract. Please note that the quoted room sizes are approximate and we advise you to verify the dimensions carefully, especially when ordering carpets, fittings, or any built in furniture. Where heating and electrical equipment is included, please be aware that we have not tested the appliances.

REF: 18684099

**W**  
**WHITES**

**01722 336422**



47 Castle Street, Salisbury SP1 3SP 01722 320600 FAX  
residential-sales@hwwhite.co.uk E-MAIL www.hwwhite.co.uk WEB

